

# Campus SIM

## How to APN Setting

Dear the valued customer,  
Thank you for the order of campus sim.  
Please read below, do it, and keep this paper.

If your sim size is Micro, use the enclosed sim adapter.

### ① APN Setting

- don't do airplane mode.
- turn on mobile network.
- if your device are dual sim, remove the another sim card and put our simcard only.
- after do APN setting, do restart your device.
- When you use another sim card (go back to your country), Please delete this APN setting.

## APN Setting (android)

- Select [Settings] from the menu
- Select [Mobile Networks] from [Wireless & networks] on the settings screen and select [Access Point Names]
- Select [New APN] from the menu and enter the above information

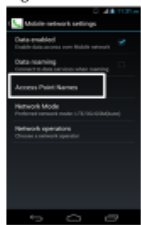

biglobe  
biglobe.jp  
user  
0000  
PAP or CHAP

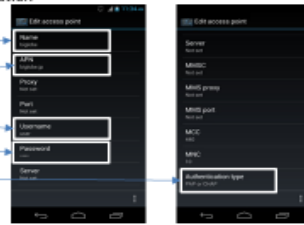

- Select [Save] from the menu buttons



APN	biglobe.jp
Username	user
Password	0000
Authentication Type	CHAPまたはPAP
PDP Type	IP

- Select the newly created APN from the Access Point Names

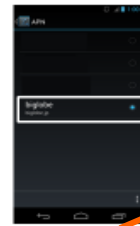

APN	biglobe.jp
Username	user
Password	0000
Authentication Type	CHAPまたはPAP
PDP Type	IP

If your phone is Galaxy, in case it does not work, Please try to change PAP.

MCC:440  
MNC:10

For the other part, you don't have to change or put anything (keep blank).

## APN Setting (iOS)

- Connect Free Wi-Fi
- Use Safari to access the following URL and download the APN configuration profile
- Tap the [Install] button on the Install Profile screen, which will open after the downloading of the configuration profile is completed.

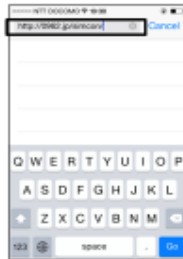

<http://0962.jp/simcon/>  
File Name: biglobeLTE3G.mobileconfig  
Size: 3.04 KB  
or  
<http://0962.jp/APN>  
or  
<http://0962.jp/ninjacon>  
or  
<http://0962.jp/d01>



- A confirmation screen for the setting change will be displayed; next tap [Install Now]



- Tap [Done]



-after downloading go to  
- `setting`  
- `general`  
- `profile` and install it

In case you go to this screen, Please reload that page!